



TECHNICAL SPECIFICATIONS

37 . 40 . 43 . 47

2018

Malö Yachts



A Malö is built like no other boat.

Every Malö that leaves the shipyard in Kungsviken is unique, specifically tailored to the customer's wishes. However, each individual boat is also crafted to our own stringent requirements on seaworthiness, safety and quality of detail.

All our hulls are built with a sandwich construction with a balsa core, as balsa offers unsurpassed rigidity, strength and crush resistance. Consequently, a Malö can withstand far more than many other yachts.

And to be extra safe, each Malö is also built according to the highly labour-intensive technique whereby a framework of transverse and longitudinal bulkheads are laminated directly inside the hull.

The hull and deck are bolted and laminated into a single unit, thus optimising rigidity and countering movement between the two sections. Another labour-intensive – but as we see it necessary – design feature that ensures the boat handles well and with maximum safety. Our focus on quality down to the finest detail is also evident in typical Malö constructions such as an acid-proof stainless steel rudderstock with a dual-bearing rudder (roller and plain bearings), solid integral rub rails, and a fibreglass-reinforced polyester Targa arch with sturdy laminated and threaded rods.

The fact that we exclusively use solid 12 mm grooved teak on the deck, superstructure and in the cockpit obviously also contributes to the unmistakable Malö quality. Just as we only use carefully selected mahogany with eight-layer matte varnish for all the cabinetry. And silkysoft matte-varnished teak flooring with koto inlay. Quite simply, we know that's the best way. From the very first concept sketch to the final drawing, and from there throughout the entire production process, a boat maker faces no end of choices between more basic and often cheaper solutions, and more labour-intensive and therefore more costly alternatives. When you choose a Malö, you can rest assured that we have never, ever taken the easy way out. We know that superior quality comes down to time, experience and know-how.

A principle we will never stray from.

This is something that we believe people who know about boats appreciate, and value as highly as we do.



DIMENSIONS

	Malö 37	Malö 40	Malö 43	Malö 47
SPECIFICATIONS				
Length overall	11,55 m / 37'10"	12,35 m / 40'6"	13,04 m / 42'9"	-
Length overall classic	11,80 m / 38'9"	12,65 m / 41'6"	13,39 m / 43'11"	14,65 m / 48'1"
Hull length	11,30 m / 37'1"	12,10 m / 39'8"	12,82 m / 42'1"	-
Hull length classic	11,55 m / 37'11"	12,40 m / 40'8"	13,17 m / 43'3"	14,40 m / 47'3"
Length waterline	9,90 m / 31'11"	10,5 m / 34'5"	10,80 m / 35'5"	11,65 m / 38'3"
Beam	3,62 m / 11'10"	3,83 m / 12'7"	3,97 m / 13'	4,12 m / 13'6"
Draught	1,80 m / 5'11"	1,92 m / 6'2"	2,00 m / 6'6"	2,08 m / 6'8"
Displacement	8,2 ton / 18,046 lbs	9,5 ton / 20,948 lbs	11,6 ton / 25,530 lbs	14,1 ton / 31,085 lbs
Ballast weight	2,7 ton / 5,954 lbs	3,6 ton / 7,938 lbs	4,2 ton / 9,259 lbs	5,5 ton / 12,236 lbs
Mast height above waterline	17,15 m / 56'3"	17,90 m / 58'9"	18,15 m / 59'7"	21,02 m / 68'11"
Length of mast	15,70 m / 51'6"	16,10 m / 52'9"	16,35 m / 53'7"	19,25 m / 63'1"

ENGINE

Type	Yanmar 4JH45	Yanmar 4JH57	Yanmar 4JH80	Yanmar 4JH110
Power	33 kW / 45 hp	42 kW / 57 hp	59 kW / 80 hp	80,9 kW / 110 hp

TANKS

Water capacity approx.	400 litre, 106 US gallon	455 litre, 120 US gallon	550 litre, 145 US gallon	820 litre, 216 US gallon
Water heater	20 litre, 5,29 US gallon	40 litre, 10,5 US gallon	40 litre, 10,5 US gallon	40 litre, 10,5 US gallon
Diesel capacity approx.	245 litre, 65 US gallon	260 litre, 68,7 US gallon	370 litre, 98 US gallon	455 litre, 120 US gallon
Holding capacity approx.	70 litre	70 litre	2x70 litre	70+90 litre
Tank quality	Acid-proof 316l, stainless steel	Acid-proof 316l, stainless steel	Acid-proof 316l, stainless steel	Acid-proof 316l, stainless steel

SAIL AREAS (APPROX.)

Main + standard genoa	68 m ² / 731 ft ²	89 m ² / 958 ft ²	98 m ² / 1055 ft ²	123 m ² / 1324 ft ²
Mainsail	37 m ² / 398 ft ²	42 m ² / 452 ft ²	45 m ² / 485 ft ²	60 m ² / 646 ft ²
Furling Genoa	31 m ² / 333 ft ² (jib)	47 m ² / 506 ft ²	53 m ² / 570 ft ²	63 m ² / 678 ft ²
Cutter staysail (optional)	17 m ² / 183 ft ²	19 m ² / 204 ft ²	21 m ² / 226 ft ²	27 m ² / 291 ft ²
Spinnaker (optional)	102 m ² / 1098 ft ²	124 m ² / 1334 ft ²	137 m ² / 1475 ft ²	162 m ² / 1743 ft ² - 182 m ² / 1958 ft ²
Gennaker (optional)	92 m ² / 990 ft ²	111 m ² / 1195 ft ²	122 m ² / 1313 ft ² - 162 m ² / 1744 ft ²	145 m ² / 1561 ft ²



SPECIFICATIONS

	Malö 37	Malö 40	Malö 43	Malö 47
HULL / LAYOUTS / STEERING (A)				
Laminated with hand lay-up method	•	•	•	•
Epoxy treatment below waterline, 3 layers	•	•	•	•
Antifouling, blue	•	•	•	•
Integral, solid moulded rubbing strake	•	•	•	•
Lead keel attached with stainless bolts (M20)	10	11	12	14
3-Bladed fixed propeller, built-in shaft log	•	•	•	•
Wheel steering with geared link system+ emergency tiller	•	•	•	•
Rudder in solid fibreglass	•	•	•	•
Stainless steel rudder shaft (SIS 2324) with two sets of roller bearings	∅ 60 mm	∅ 45 mm	∅ 50 mm	∅ 60 mm
MAST, RIG, SAILS (B)				
Seldén silver anodised mast with a double pair of swept-back spreaders	•	•	•	•
Headsail furling system	•	•	•	•
Andersen halyard winch on the mast	•	•	•	•
Andersen reefing winch on the mast	•	•	•	•
Deck light	•	•	•	•
Steaming light	•	•	•	•
Windex and flag yards	•	•	•	•
Rod kicker	•	•	•	•
Aluminium rigging screw protection	○	•	•	•
Masthead rig	-	-	•	-
Fractional rig 19/20	•	•	-	•
Detachable cutter stay	○	○	•	•
Mainsail Dacron, 2 reef	2+2 batten (alt. full batten)	2+2 batten (alt. full batten)	2+2 batten (alt. full batten)	2+2 batten (alt. full batten)
Genoa standard, Dacron	107 % (jib)	135 %	135 %	135 %
Mainsail cover (beige colour)	•	•	•	•
DECK EQUIPMENT (C)				
Teak on deck and coach roof (12mm)	•	•	•	•
Harken blocks	•	•	•	•
Harken genoa and mainsheet system	•	•	•	•
Andersen self tailing genoa winches	2x46 ST	2x52ST	2x58ST	2x58ST
Andersen main and halyard winches	2x12ST	2x28ST	2x40ST	2x46ST
Large self-draining anchor well in stern	•	•	•	•
Windlass in bow	○	Manual	Electric	Electric

• standard

○ optional



	Malö 37	Malö 40	Malö 43	Malö 47
Anchor chain (calibrated)	40 m line, 5 m chain	40 m chain, Ø8 mm	60 m chain, Ø8 mm	60m chain, Ø10 mm
Anchor	15 kg	20 kg	30 kg	30 kg
Pulpit and pushpit in stainless steel	Ø 25 mm	Ø 30 mm	Ø 30 mm	Ø 30 mm
Dorade ventilators	2	2	3	4
Portlights (stainless steel)	11	11	11	16
Skylights	3	3	2	4
Stainless steel mooring and midships cleats	6	6	6	6
Grab rails on the coach roof	•	•	•	•
Fenders (blue, 9" x 20")	4	6	6	6
Mooring lines, 10 m Ø 19 mm	4	6	6	6
Winch handles, lockable	2	2	2	2
Flag pole	•	•	•	•
COCKPIT / TARGA-ARCH / WINDSCREEN (D)				
Teak (12mm) on all soles in cockpit	•	•	•	•
Steering pedestal with stainless steel protection bar	•	•	•	•
Steering wheel (leather covered)	Ø 900 mm	Ø 900 mm	Ø 1000 mm	Ø 1100 mm
Manual bilge pump	•	•	•	•
Long cockpit table in teak (100x75cm)	•	•	•	•
Folding pad eyes	3	3	3	3
Washboard in teak with louvered vents sliding into a stainless steel frame.	•	•	•	•
Sliding hatch with a clear top to add light below	•	•	•	•
Targa arch with mainsheet system (Harken) over cockpit	•	•	•	•
Sprayhood (beige)	•	•	•	•
Cockpit extension with removable side panels (beige)	•	•	•	•
Fixed stainless steel windscreen	•	•	•	•
INTERIOR EQUIPMENT (E)				
Corian in galley and head compartments	○	○	•	•
Cooker with oven and 2 burner stove (Malö 47: 3-burner)	•	•	•	•
Isotherm SP water cooled fridge (top loading)	75 ltr.	75 ltr.	75 ltr.	75 ltr.
Isotherm SP water cooled freezer (top loading)	○	○	○	53 ltr.



SPECIFICATIONS

	Malö 37	Malö 40	Malö 43	Malö 47
Single Lever faucet for hot and coldwater in galley and head	●	●	●	●
Pressurized hot & cold water system	●	●	●	●
Cabin heater Eberspächer	○	Airtronic 5	Hydronic 5	Hydronic 10
Shower with single lever faucet in head	●	●	●	●
Electric shower drain pump	●	●	●	●
Bilge pump electric with float switch	●	●	●	●

NAVIGATION/INSTRUMENTS/COMMUNICATION (F)

Illuminated compass	●	●	●	●
Raymarine I70s x 2, speed/depth/wind transducer	●	●	●	●
Raymarine I70s display in the navigation area	○	●	●	●
Raymarine MFD mounted at sb side companionway	○	Axiom 9	Axiom 12	Axiom 12
VHF Raymarine Ray50 with masthead aerial	○	●	●	●

TECHNICAL EQUIPMENT: ELECTRICITY / HEATER / LPG (G)

				12V+24V
Electrical system	12V	12V	12V	
Service batteries	230Ah	280Ah	450Ah (AGM)	100Ah (12V)+ 450Ah(24V)(AGM)
Engine battery	75Ah	75Ah	75Ah (AGM)	75Ah (AGM)
Alternator 12V	80A	80A	80A	80A
Alternator 24V	-	-	-	65A
Gas bottles (3kg)	●	●	●	●
Gas leak detector	●	●	●	●

SAFETY EQUIPMENT / OTHERS (H)

Boarding ladder on stern	●	●	●	●
Boat hook	●	●	●	●
Fire extinguisher	2	2	3	3
Fire blanket	●	●	●	●
Lifebuoy with light and holder	●	●	●	●
First aid kit	●	●	●	●
Fittings for lifelines on deck	●	●	●	●



malö

37

INTERIOR LAYOUTS

STANDARD

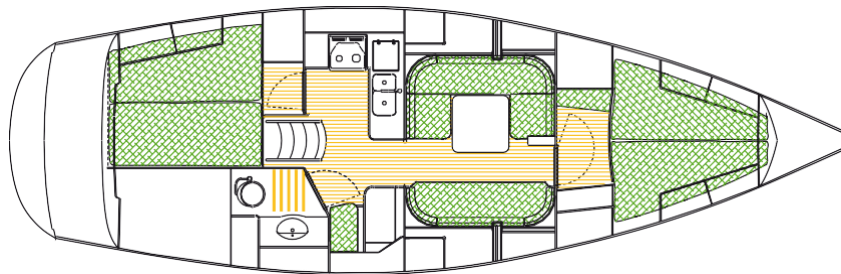

ALTERNATIVE

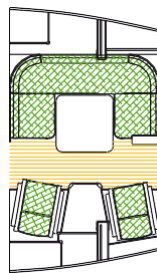

Double armchairs

malö

40

INTERIOR LAYOUTS

STANDARD

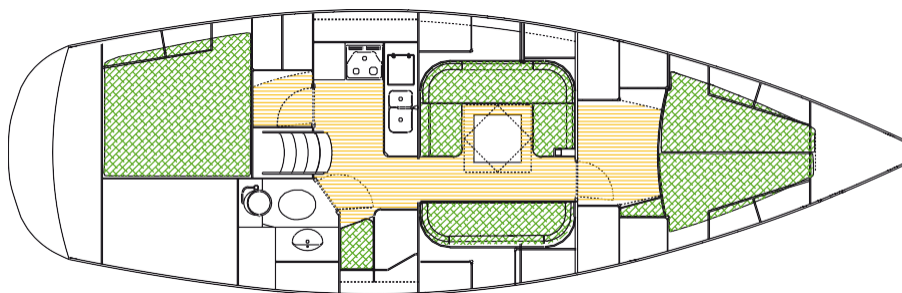

ALTERNATIVE

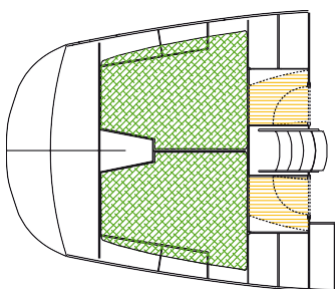

Double aft cabins

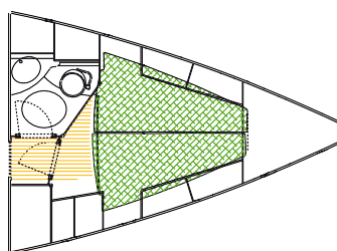

Fore cabin no. 2

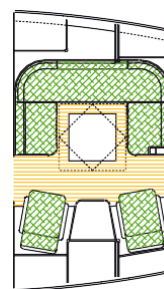

Double armchairs

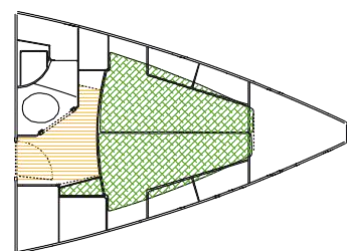

Fore cabin no. 3



Malö
43

INTERIOR LAYOUTS

STANDARD

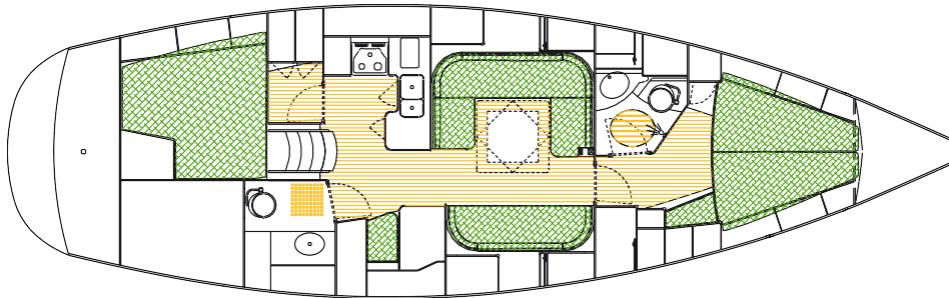

ALTERNATIVE

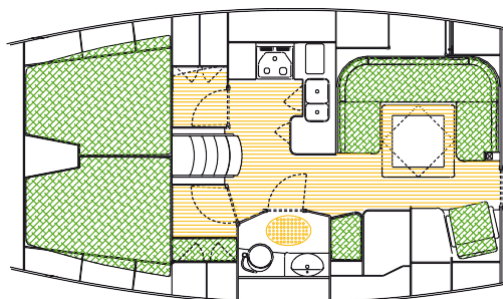

Double aft cabins

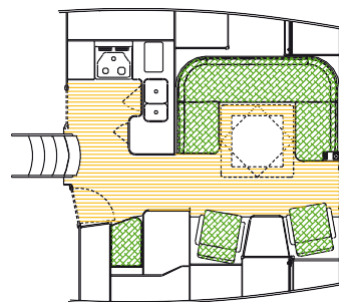

Double armchairs

Malö
47

INTERIOR LAYOUTS

STANDARD

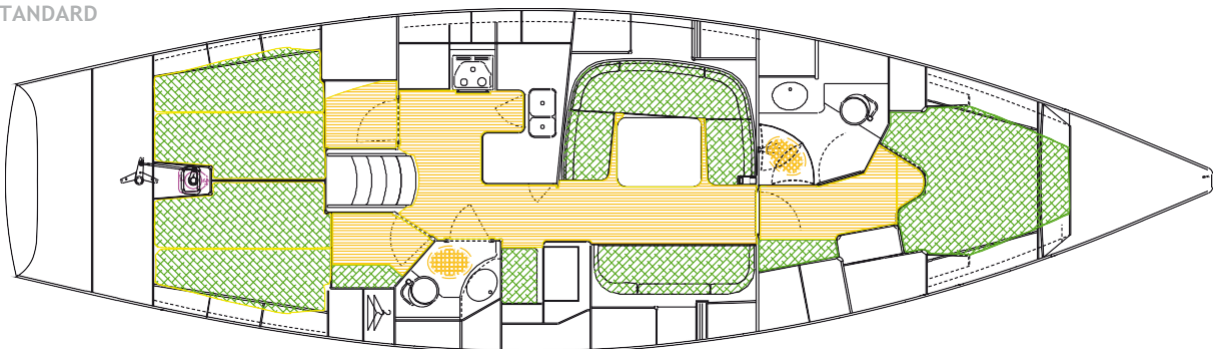

ALTERNATIVE

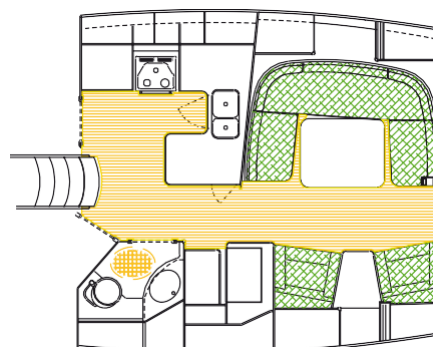

Double armchair



Malö Yachts

MALÖ YACHTS • KUNGSVIKEN 722 • 473 99 HENÅN • SWEDEN
+46 (0)304 31665 • sales@maloyachts.se • www.maloyachts.se
PART OF THE SWEDEN YACHTS GROUP

